

## INSTALLATION INSTRUCTIONS

### WOOD KNIFE BLOCK INSERT

#### ESTIMATED ASSEMBLY TIME:

**15 MIN**

#### CARE AND MAINTENANCE:

Clean with a damp cloth and wipe parts dry.

#### STEP 1

For the 24" drawer box application, the divider will be required. Narrower applications will not need the divider (See Fig. 1).

#### STEP 2

Insert with the divider can be utilized in wider applications to maximize storage (See Fig. 2A).

#### STEP 3

Installation complete (See Fig. 3A).

#### INSTALL INSTRUCTION:

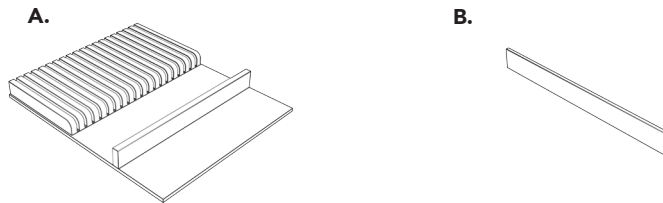

Parts List		
No.	Description	Qty
A	Knife block insert	1
B	Divider	1

FIG. 1

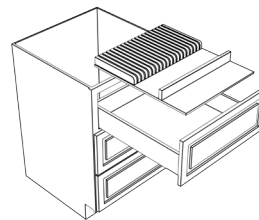

FIG. 2

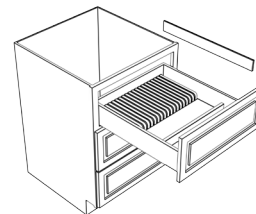
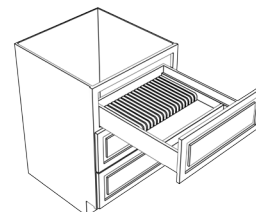

FIG. 3





12400 Earl Jones Way  
Louisville, KY 40299  
rev-a-shelf.com  
800-626-1126

